

LANDIS VALLEY VILLAGE & FARM MUSEUM WEDDINGS



VINTAGE ELEGANCE
IN A HISTORIC SETTING

In Frame Productions



Janae Rose Photography

LANDIS VALLEY WEDDING VENUES

YELLOW BARN & COURTYARD SEATS UP TO 225 PEOPLE

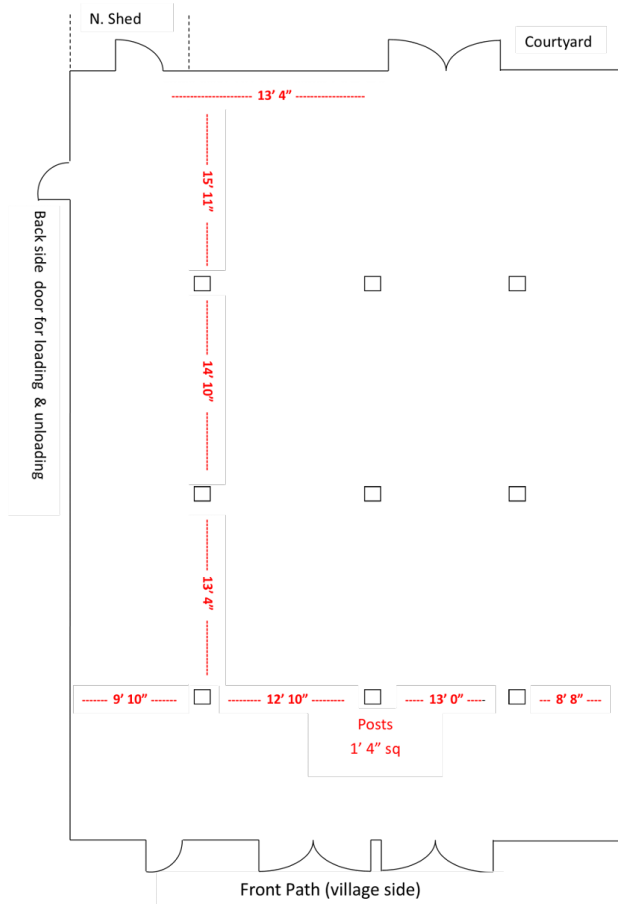

LANDIS VALLEY WEDDING VENUES

THE FIREHOUSE SEATS UP TO 100 PEOPLE

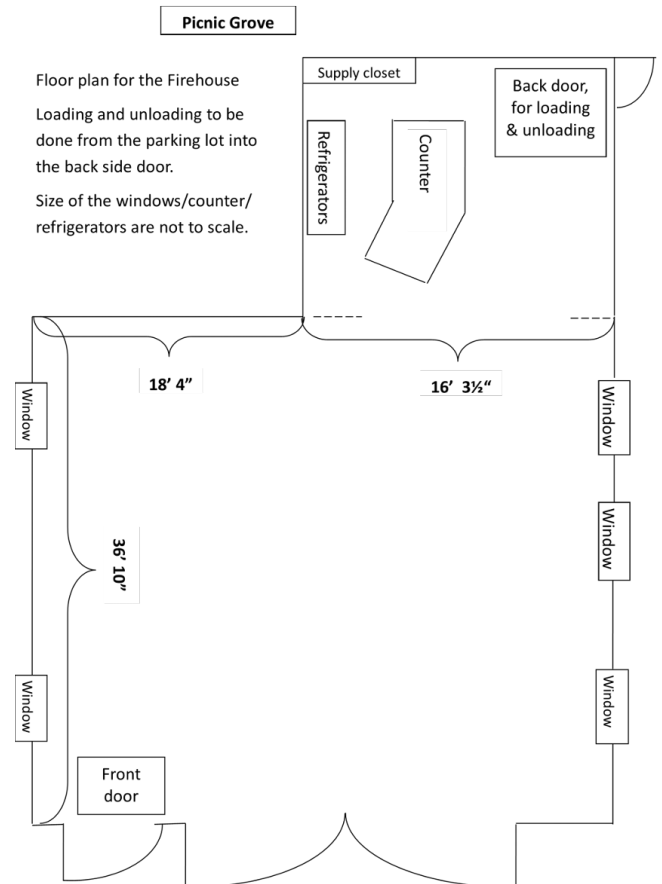

LANDIS VALLEY WEDDING VENUES

HISTORIC LANDIS VALLEY HOUSE HOTEL

HISTORIC 1860'S BUILDING
SEATS UP TO 40 PEOPLE

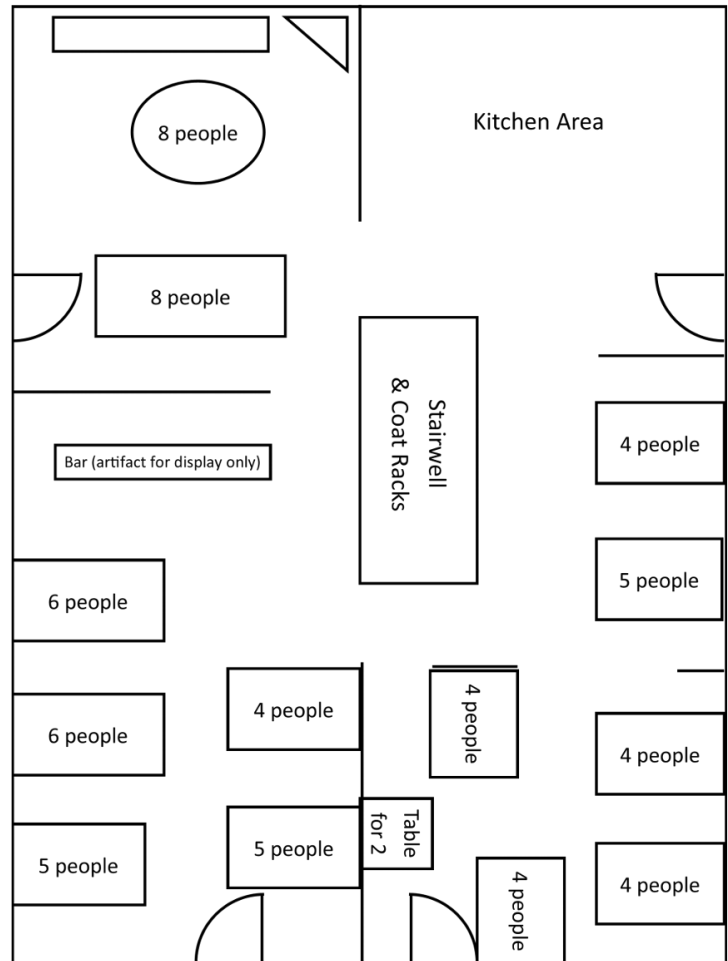

PRICING PACKAGES: THE STANDARD

Available March - December, Friday, Saturday, Sunday

Yellow Barn Package: \$5,900

Maximum Capacity: 225

Day-of access beginning at 9 AM

Event 5 PM - 11 PM, Clean-Up 11 PM - 12 AM

*Courtyard, *Ceremony *Dressing Area* Wi-Fi

*Tables/Chairs & the set-up/tear-down

*Landis Valley Rental Attendant

Fire House Package: \$3,000

Maximum Capacity: 100

Day- of access beginning at 9 AM

Event 5 PM - 11 PM, Clean-Up 11 PM - 12 AM

*Outdoor Space *Ceremony *Wi-Fi

*Tables/Chairs & the set-up/tear-down

*Landis Valley Rental Attendant

The Landis Valley House Historic Hotel Package: \$1,500

Max capacity: 40

Day-of access beginning at 9 AM

Event 5 PM - 11 PM, Clean-Up 11 PM - 12 AM

*The Historic Hotel porch *Ceremony *Wi-Fi

*Tables/Chairs & the set-up/tear-down

*Landis Valley Rental Attendant

Open Venue: Use Caterer, Photographer, Florist and DJ of your choice, decorate the way you want, simple and elegant to fancy themed weddings!

Add-ons:

Open Flame Attendant: \$200: required for all live flame candles and fire pits.

Add Fire House with rental of Yellow Barn \$1,200

Economy Packages available

LANDIS VALLEY WEDDING FAQs

1. How is the Yellow Barn, Firehouse or Historic Hotel set-up?

We will give you a floor plan of the space so you can design the layout you want. Tables and chairs are included, we have round and/or rectangular tables, and they can be configured to fit your needs, including an area for dancing.

2. Is the Yellow Barn heated or air conditioned? A propane heater will comfortably heat the Yellow Barn. This is provided October through May. There is no AC. There are ceiling fans and 3 floor fans. Additional fans can be rented.

3. Is the Firehouse or Historic Hotel heated or air conditioned?

Heat and AC are standard in the Firehouse and the Historic Hotel.

4. What happens if there is inclement weather?

You can plan for a ceremony and reception to be in the building and have your guests sit at their assigned tables. If in the Yellow Barn, the best option is to rent the Firehouse in conjunction with the Yellow Barn for \$1,200 which will accommodate up to 180 guests for ceremony seating. This fee must be paid in advance to have the Firehouse booked for your wedding event.

5. Do you have preferred caterers?

Many caterers have come to LVM and we have a short list that you may find helpful. You may use any caterer you choose. Caterers new to the site are required to make an appointment with us to view the site. Caterers need to provide a certificate of insurance.

6. Is liability insurance policy needed?

Yes. A certificate of insurance is required for all functions. You may obtain a rider on your existing homeowner's policy or parent's policy or purchase a policy for the day over the internet. This policy must include Host Liquor Coverage if you are serving alcohol.

7. Are Pets permitted?

Landis Valley is a working farm, for the safety of the Farm animals and your pets, pets are not permitted on the Museum Grounds. Pictures with pets are permitted outside the fence on the Museum perimeter.

8. How is trash handled?

You are responsible for removing everything you bring in including the trash created by your rental. We provide trash cans and liners. Use of our dumpsters are included too. You do not need to take the trash with you.

9. When can the wedding party use the Yellow Barn, Firehouse and Hotel for set-up and rehearsal?

If there is no other event taking place in the Yellow Barn, Firehouse or Hotel the day prior to your scheduled date, you can come in the day prior between 3:00—6:00 PM to set-up and have a rehearsal for an additional fee of \$500. If the day prior is not available, you have access to your rented area the day of your scheduled event.

10. What is required to rent the space?

Once you decide on a date, we will issue a contract. A payment of 25% of the total rental and a \$500 security deposit are due at signing. The \$500 security deposit will be held and refunded if there is not damage or major infractions of our rules.

LANDIS VALLEY WEDDING SITE TOUR

We would love to meet with you!

We would like to meet with you and show you the many options that are available for your special day. Landis Valley Village & Farm Museum is located in scenic Lancaster, PA, just off of Route 30 and a reasonable drive from Philadelphia, Baltimore, New Jersey, Delaware, and New York.

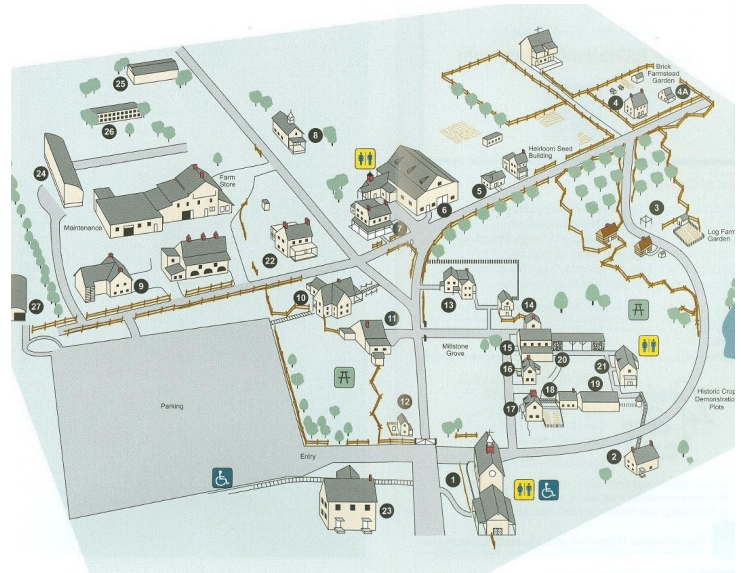

To schedule an appointment,

Contact us

2451 Kissel Hill Rd.

Lancaster, PA 17601

Katelyn.Hess@landisvalleyassociates.org

Terry.Kreider@landisvalleyassociates.org

Situated on 100 acres in Lancaster, PA, Landis Valley Village and Farm Museum is a living history village that collects, preserves and interprets the history and material culture of the Pennsylvania German community from 1740 to 1940. The museum, a 501(c)(3) nonprofit, is administered by the Pennsylvania Historic & Museum Commission with the active support of the Landis Valley Associates (a registered charitable organization).

updated 8/2022

In Frame Productions

